

4

3

2

1

Notes:

- 1. For ES135 to ES180, 15, 50, and 100 psi trims, 208V & 240V, 3 ph
- 2. Boiler is UL listed to standard 834
- 3. Materials of construction:
  - 1. Vessel and Piping: Carbon Steel
  - 2. Jacket: Stainless Steel
- 4. Pressure vessel built in accordance with ASME Section 1 and carries an "M" stamp
- 5. Completed boiler is built in accordance with ASME Section 1 and carries an "E" Stamp
- 6. Refer to Technical Data Sheet at [www.sussmanboilers.com](http://www.sussmanboilers.com) for more information

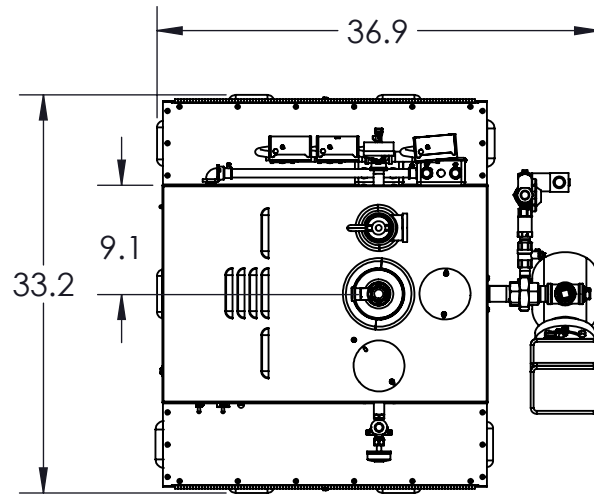

Top

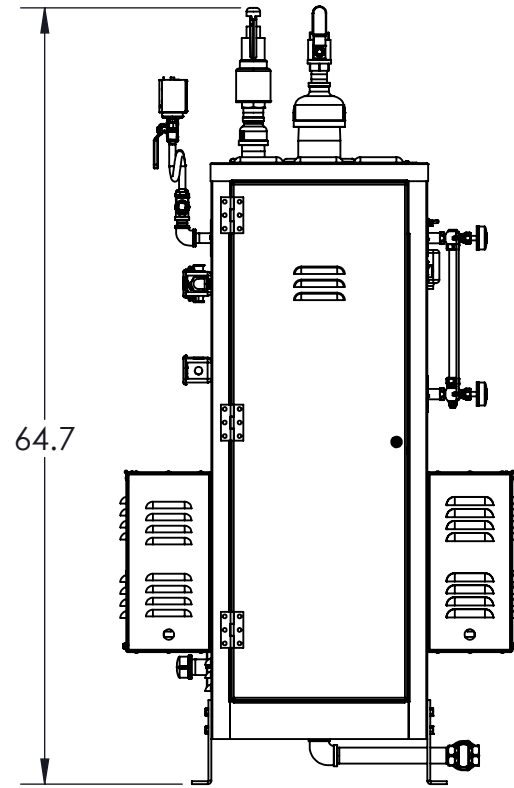

Left

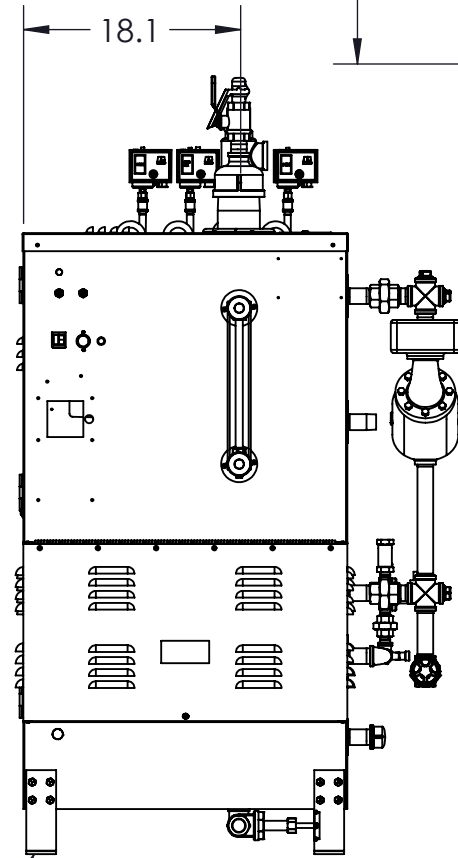

Front

Mounting Holes:  
4 x Ø .4"

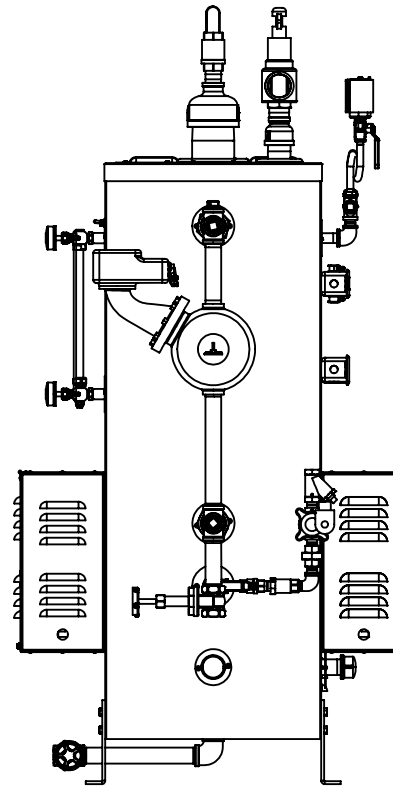

Right

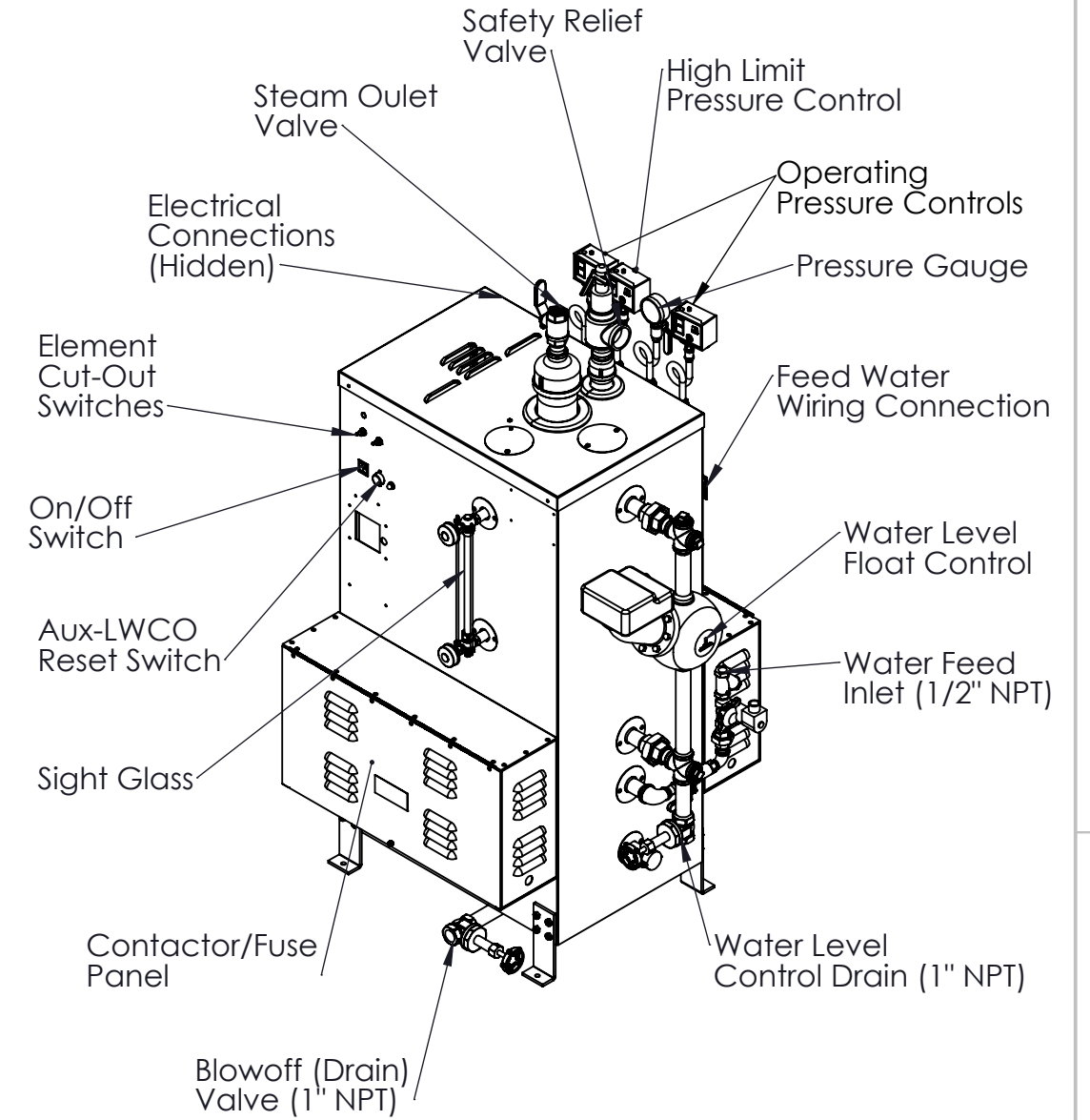

DIMENSIONS ARE SHOWN IN INCHES [CENTIMETERS]  
 TOLERANCES ARE AS FOLLOWS UNLESS OTHERWISE SPECIFIED  
 X.XX X.XXX X.XXXX ANGULAR FINISH  
 ±.12 ±.031 ±.0156 ±1.0° 250  
 REMOVE AND DEBURR SHARP EDGES AND CORNERS  
 ALL DIMENSIONS ARE AFTER FINISH OR PLATING  
 REFERENCE DIMENSIONS ARE SHOWN IN PARENTHESES ( )  
 CRITICAL DIMENSIONS ARE SHOWN IN

THIS DRAWING AND/OR SPECIFICATIONS ARE THE PROPERTY OF DIVERSIFIED HEAT TRANSFER INC. THIS CONFIDENTIAL AND PROPRIETARY INFORMATION SHALL NOT BE USED, COPIED OR REPRODUCED IN ANY MEANS AS THE BASIS FOR MANUFACTURE OR SALE OF APPARATUS WITHOUT WRITTEN AUTHORIZATION FROM OWNER.



439 MAIN RD. TOWACO NJ 07082  
 PHONE: (800) 221-1522 FAX: (718) 386-7809

TITLE  
 ES135-ES180 ELECTRIC STEAM BOILER  
 15 PSI, 50 PSI, 100 PSI, 208V & 240V/ 3PH

1		FOR RELEASE	JH	12/28/23
REV	ECN	REVISION DESCRIPTION	NAME	DATE

THIRD ANGLE PROJECTION	DWG. SCALE	MATERIAL SPEC:	NAME	DATE	DWG#	REV
	1:16		JH	12/28/23	ES135-ES180	
			CHECKED BY		SHEET 1 OF 2	

4

3

2

1

4

3

2

1

## Notes:

1. Minimum 1" clearance to all combustible materials
2. Service clearances to be in conformance to NEC requirements

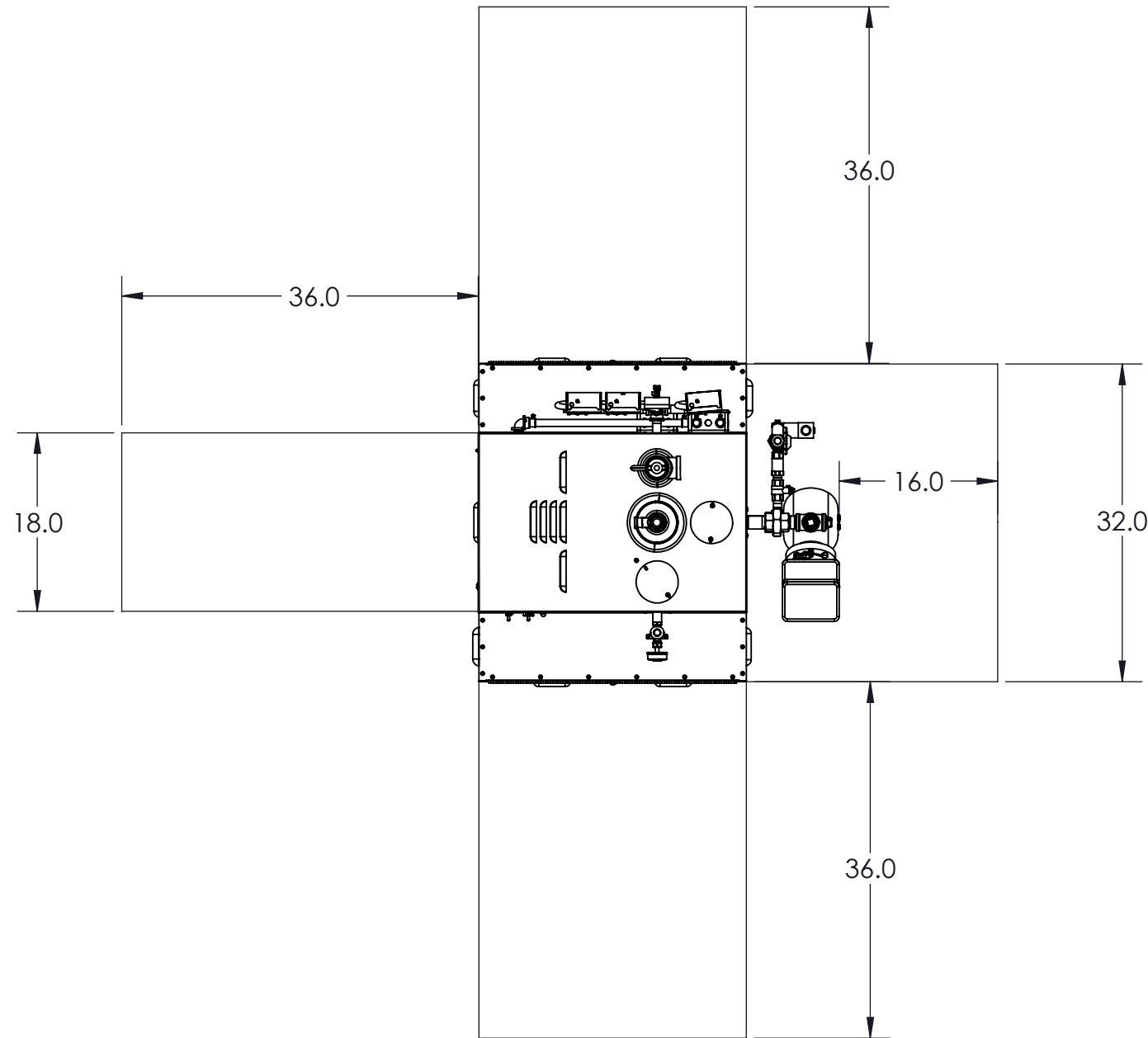
Service Clearance Requirements

Boiler	kW	Pressure	Elements	Voltage	Amp Draw	Control Voltage	Steam Flowrate (lbs/hr)	Feed Water Consumption (GPM)	Reccomended Min. Feed Water Rate (gpm)
ES135	142	15 50 100	8 x 18kw	208	395	120	433	0.87	2.6
				240	342				
ES160	157.5		7 x 22.5kw	208	438				
				240	379		475	0.95	2.9
ES180	180		8 x 22.5kw	208	500		542	1.09	3.3
				240	434				

Boiler	Total Volume (gal)	Operating Volume (gal)	Dry Weight	Wet Weight	Shipping Weight	Steam Outlet Size (NPT)	Water Feed Inlet Size (NPT)	Drain Outlet Size (NPT)	Safety Valve Outlet Size (NPT)
ES135	36.5	22.8	638	836	720	1-1/2" (15) 1" (50 & 100)	1/2"	1"	1-1/2" (15)
ES160									1" (50)
ES180									1-1/4" (100)

Note: All weights do not include options. See option drawings for additional weights

DIMENSIONS ARE SHOWN IN INCHES (CENTIMETERS)  
TOLERANCES ARE AS FOLLOWS UNLESS OTHERWISE SPECIFIED  
X.XX X.XXX X.XXXX ANGULAR FINISH  
±.12 ±.031 ±.0156 ±1.0° 250  
REMOVE AND DEBURR SHARP EDGES AND CORNERS  
ALL DIMENSIONS ARE AFTER FINISH OR PLATING  
REFERENCE DIMENSIONS ARE SHOWN IN PARENTHESES ( )  
CRITICAL DIMENSIONS ARE SHOWN IN

THIS DRAWING AND/OR SPECIFICATIONS ARE THE PROPERTY OF DIVERSIFIED HEAT TRANSFER INC. THIS CONFIDENTIAL AND PROPRIETARY INFORMATION SHALL NOT BE USED, COPIED OR REPRODUCED IN ANY MEANS AS THE BASIS FOR MANUFACTURE OR SALE OF APPARATUS WITHOUT WRITTEN AUTHORIZATION FROM OWNER.



439 MAIN RD. TOWACO NJ 07082  
PHONE: (800) 221-1522 FAX: (718) 386-7809

TITLE  
ES135-ES180 ELECTRIC STEAM BOILER  
15 PSI, 50 PSI, 100 PSI, 208V & 240V/ 3PH

1	FOR RELEASE	JH	12/28/23	THIRD ANGLE PROJECTION	DWG. SCALE	MATERIAL SPEC:	NAME	DATE	DWG#	REV
REV	ECN	REVISION DESCRIPTION	NAME	DATE	1:16		DRAWN BY	JH	12/28/23	ES135-ES180
							CHECKED BY			SHEET 2 OF 2

4

3

2

1